

Installation Procedure for EcoSmart Stone and TechStone for Timber or Metal Framed Structures



Smartstone[®]
systems



Installation Procedure for EcoSmart Stone and TechStone Products

for Timber or Metal Framed Structures

1. Getting started

There are a few decisions that should be made before ordering your EcoSmart Stone or TechStone products. Such as the type of stone, and the style of stone e.g. 300 Series or 600 Series etc. You should also decide on corner treatments, whether they are a different stone or texture to complement the body stone.

Fast Facts

1. 300 Series stone are all 298mm > 299mm in height (300mm centres with the SmartClips thickness) They are usually used in a mixed size range of 400mm, 500mm and 600mm lengths placed randomly to suit style and fit.
2. 300 Series corners are 400mm x 200mm and these can be used also in conjunction with the Ashlar Series panels to highlight the corners.
3. Ashlar Series is 1200mm in length and the same height as the 300 Series (298mm > 299mm) These are supplied with spare stone to place in the interlocking section of the panel. These are simply glued into place once all the panels are installed.
4. At the planning stage you should consider the window treatments required/preferred, as the size of the window frames will dictate what can be done, or not. These decisions should be made early for your window supplier to accommodate your preferences. The least expensive style (least work) is to have the window frames made and finished to extend externally at least 80mm from the wall studs. This allows the wall stone to be butted and sealed to the frames without the need for stone with side returns for doors and windows. Sills if required can still be used with this installation if desired. Many standard window frames only protrude 20mm > 30mm from the studs thus will require reveal stone or blocks with setbacks on the sides. The result is the window frame will sit back around 40mm from the front face of the stone cladding.
5. Reveal stone is not available with the Ashlar Series so the options are as first in above paragraph, where bigger window frames are used and the stone butted into them. The second option with standard window frames is to use Window/Door returns #2 and the Sills #2 styles in our catalogue.
6. 300 Series may be purchased with clean cut edges for a pencil joint finish, or with bevelled edges which allows flexible grout to be applied after the installation completion.
7. TechStone is available in the same sizes/format as the 300 Series and will soon be available in a 600 Series. (1200 mmx 600mm)
8. Our staff are available and ready to assist you with any areas where further clarity is required relevant to your personal project. If specific size requirements need fulfilled we can assist subject to quantity.

Installation Procedure for EcoSmart Stone and TechStone Products for Timber or Metal Framed Structures

2. You will need

1. 300 Series or Ashlar stone, corners and sills, starter rails, alignment joiners and SmartClips .
2. 10G x35/40mm length hex head galvanized screws, 30mm self drilling if for metal frame.
3. Credible brand Silicone or Polyurethane adhesive and applicator.
4. Battery or electric screw driver with hex driver bit.
5. Dumpy level, digital level, spirit level or a water level.
6. 300m capable mitre saw, or table saw, or 125mm angle grinder with diamond turbo blade.
7. Tape measure, a set square and a 20mm wide snap-off blade knife.
8. 18-19mm x 40mm treated primed timber battens for soffit and window finishing's where required.
9. Small movable worktable to work on for cutting and trimming tasks.
10. 75mm x 50mm x 1.5mm > 2mm 'L' section folded gal metal or aluminium for lintels where required.

Items 1, 2, and 3 components are usually supplied together with the stone cladding order.

Cutting EcoSmart Stone or TechStone is quite simple and quick due to the thin stone laminate. They can be cut with wet or dry turbo/diamond blades. If using dry cutting machinery and blades ensure an adequate breathing filter apparatus is worn along with earplugs for safety. Portable circular saws are not advisable as they cut blade up at front which can cause chipping to the face of the stone surface. All cutting should be performed with the blade running downwards at the front of the cuts.

Ensure the structure has DPC where required at base plate of studs and all walls are lined with appropriate standards approved breather foil to manufacturers instructions prior to the application of any SmartStone products. The bottom starter rails are supplied with pre-punched weep holes.

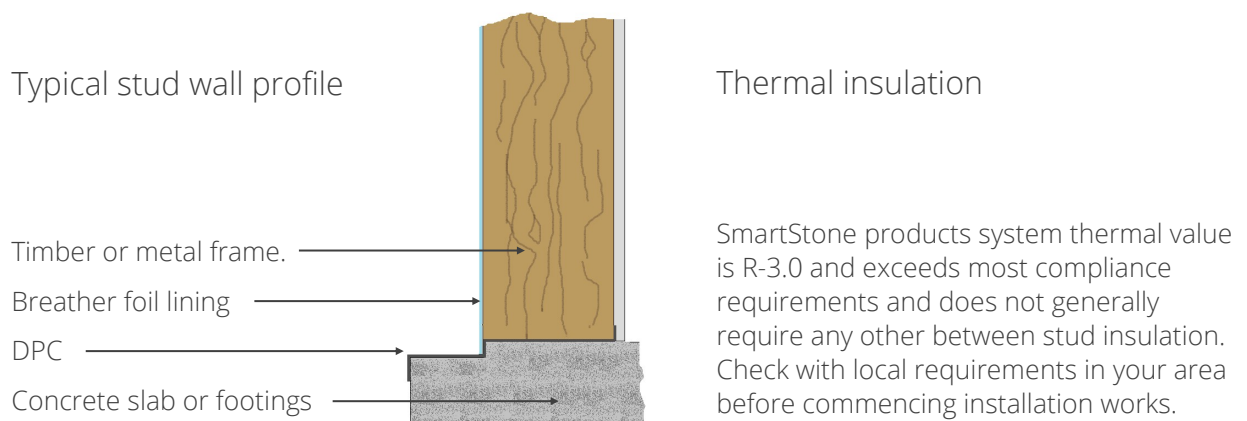

3. General

All SmartStone products have an overall thickness of between 55mm and a 60mm maximum depending on the stone type and finish chosen. With the SmartClip installation the cavity is 18mm/19mm resulting in the finish being > 80mm from the stud wall.

Start the installation by fixing the starter rail with fixing screws no more than 600mm centres. Ensure this rail is perfectly plumb and level as this dictates the accuracy of the whole product installation. SmartStone Systems product is calibrated to plus/minus 0.5mm tolerances on all stone height measurements. With this easy and slight adjustments can be made as installation progresses with no visual impairments to line and level.

Fixing the stone cladding should begin firstly with the corners being positioned in place with at least 2 fixing brackets per corner. Glue as Fig B1 below. Place the corner in the starter rail ensuring overlapping allowance to the next block being fitted. The PVC alignment tongue joiners should be placed in each vertical abutment. And across each horizontal joint abutment to every block as they are installed.

Waterproofing is achieved by placing a 5mm bead of adhesive sealant in an unbroken line just behind the fitting groove (see Fig B4) on all horizontal and vertical joints/abutments. Should adhesive get on the face of the stone it is BEST to simply leave to cure, and cut out later. Attempts to clean wet adhesive can result in smears on the stone which can be very difficult to remove without marring its beauty.

Working from one corner to the other choose the size stone to best suit the opening. When meeting the other corner it is best to check opening left at about 1800mm, (6ft) and see which size combination suits the balance of the opening to be filled, and make the smallest final cut to suit. This can be cut with the turbo diamond blade affixed to your cutting tool of choice. Check for fit before applying glue, adjust if required, apply glue and fit into place. (These are best fitted BEFORE the vertical joiners are placed in the grooves) Once in place and aligned then slide joiners down the grooves each side from the top.

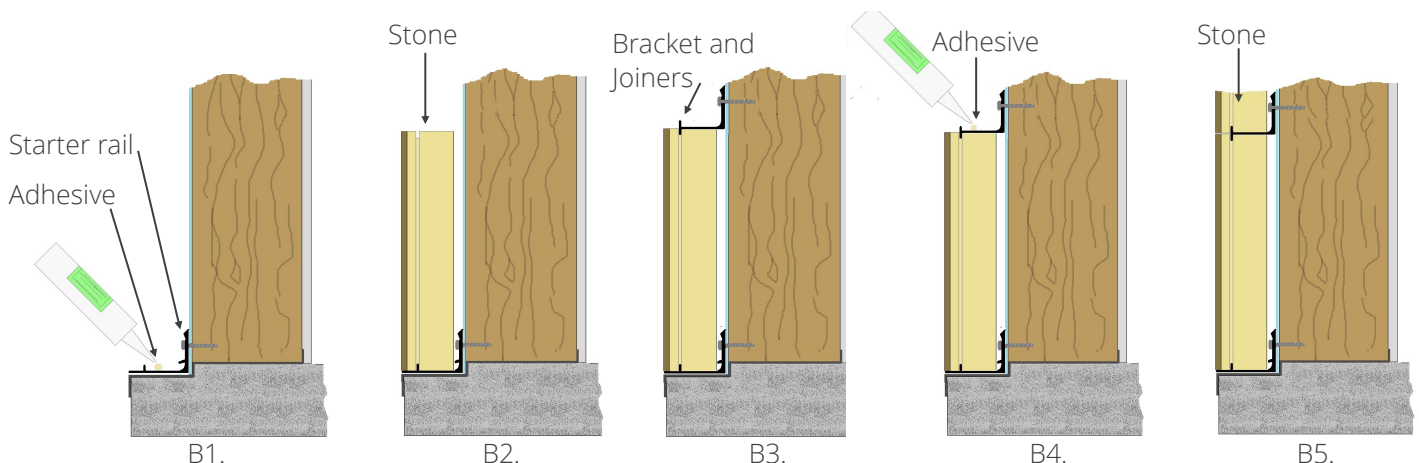
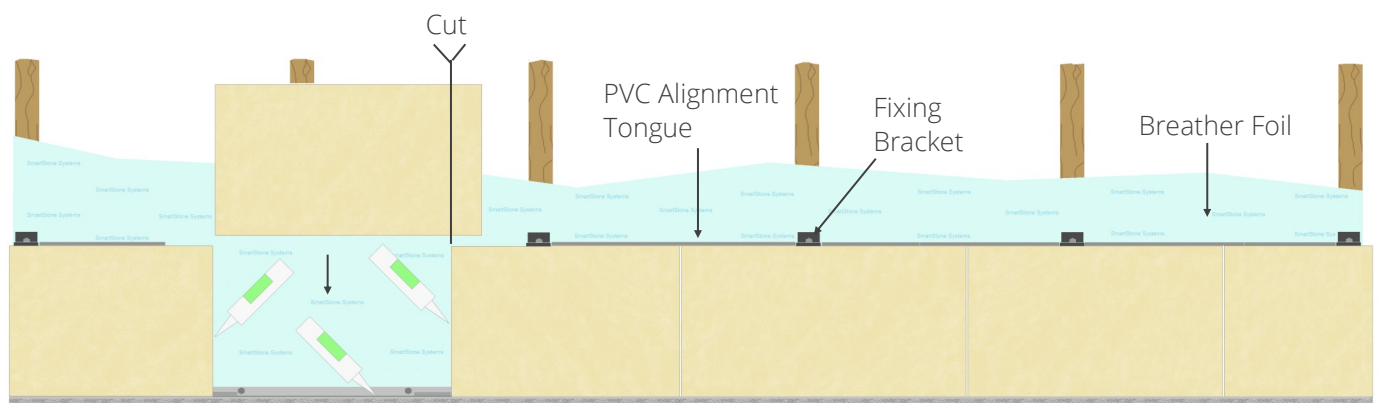

4. Window Sills

Where window sills are to be used then 42mm x 18mm treated/primed battens should be placed below each window frame and fixed with 40mm screws. These battens should also be placed directly underneath soffits and top/bottom of any sloping gable areas.

Body stone is likely to require trimming to allow for sill placements. These can simply be re-grooved to allow for clip installation after trimming.

Adhesive should be applied to the bottom body stone and along the batten prior to fitting the sills. Note that all openings should also be sealed completely around all frames on completion to ensure there is a totally waterproof finished substrate. Illustration shows a #2 sill option using 100mm x 30mm solid stone.

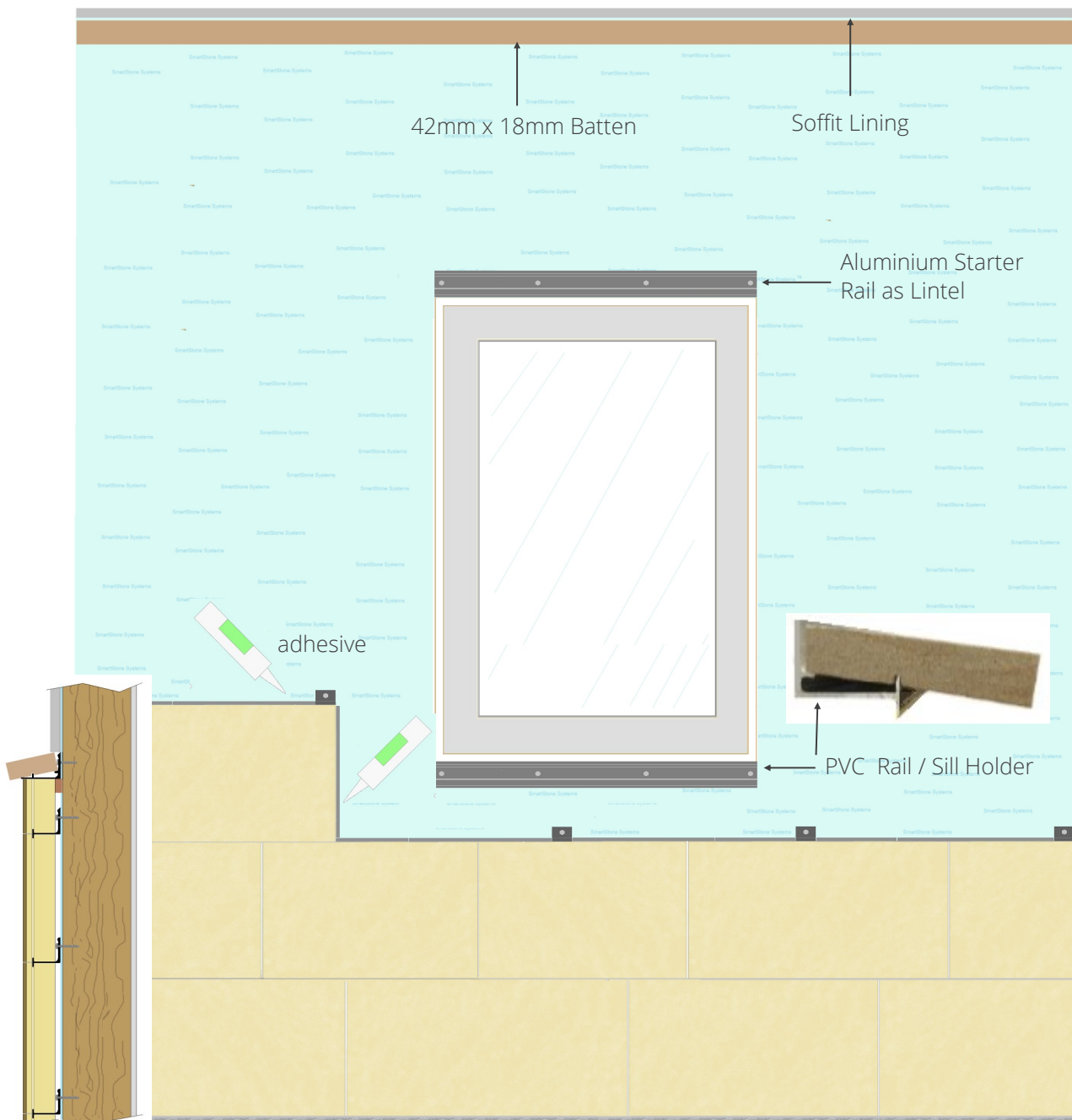

Sill Detail

5. Window and Door Surrounds

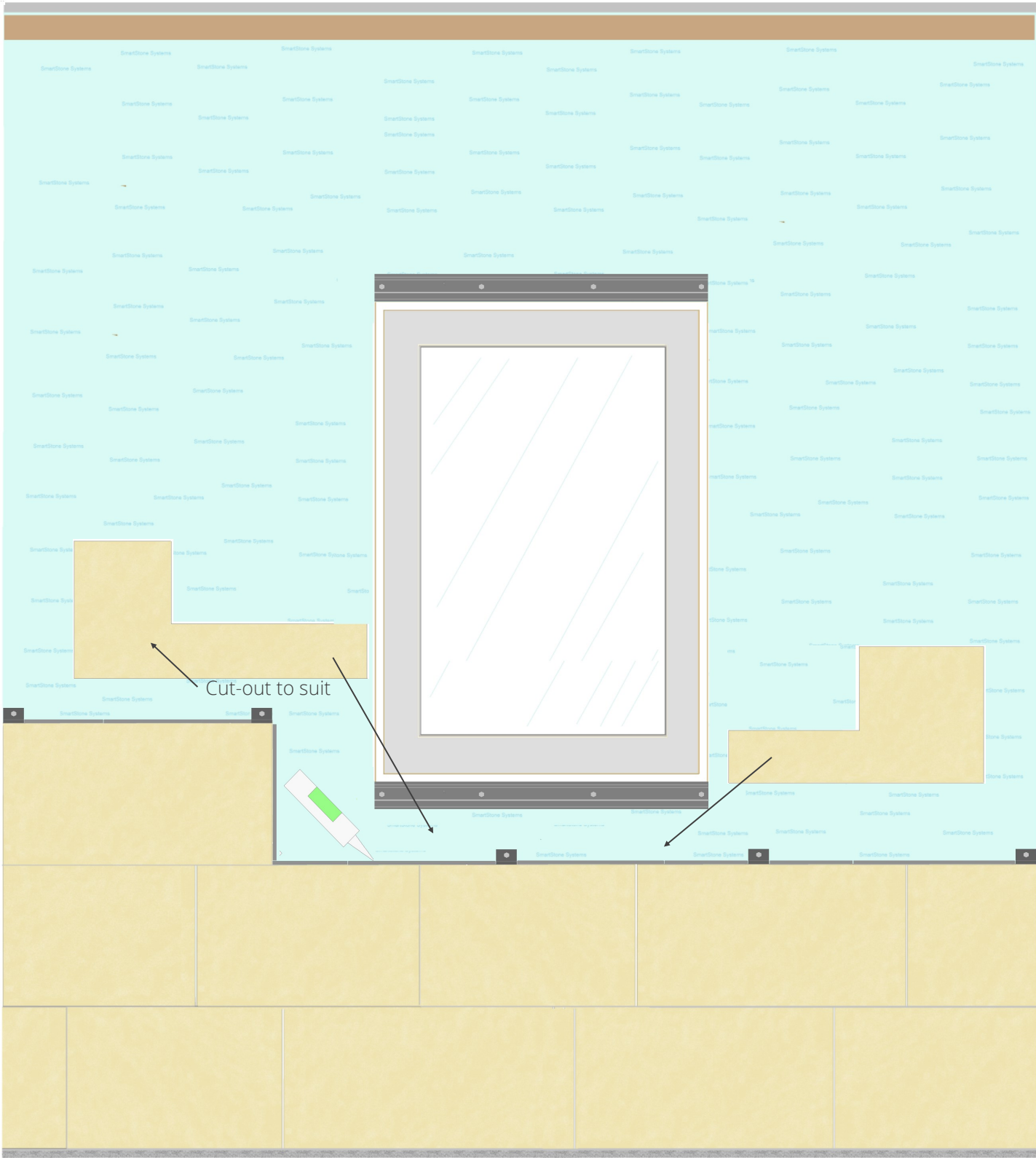

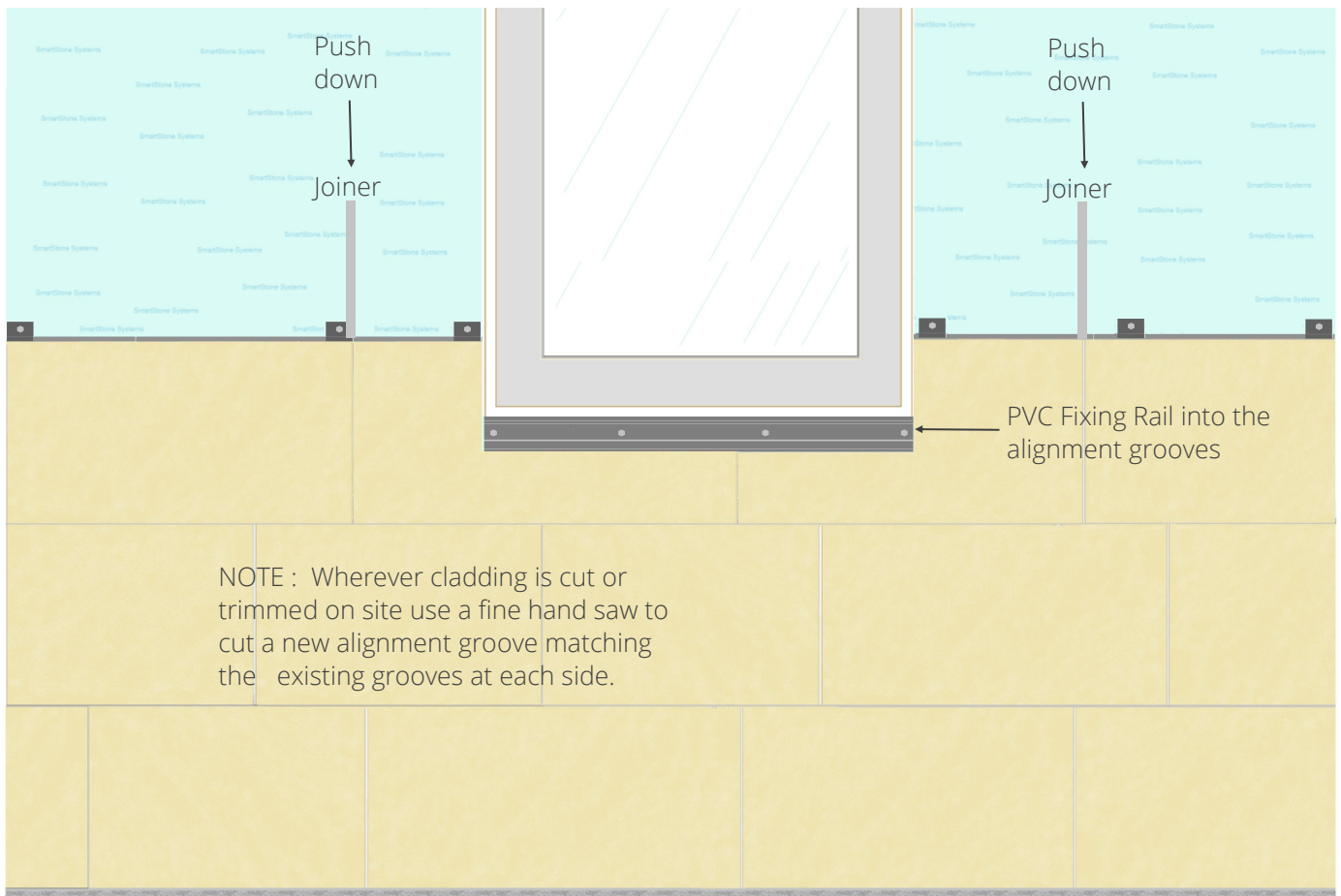

6. Window and Door Surrounds

The following examples are illustrations of the three window/door opening options. #2 reveals are using the aluminium starter rail around the perimeter of each frame which the wall stone then butts into. Remember #3 option needs to be considered before ordering window and doors from suppliers to accommodate this option. It may cost a little more but it does save money/time on installation labour over the extra cost of the reveal stone in either #1 or #2. Option #3 also allows for installation without sills being required if desired.

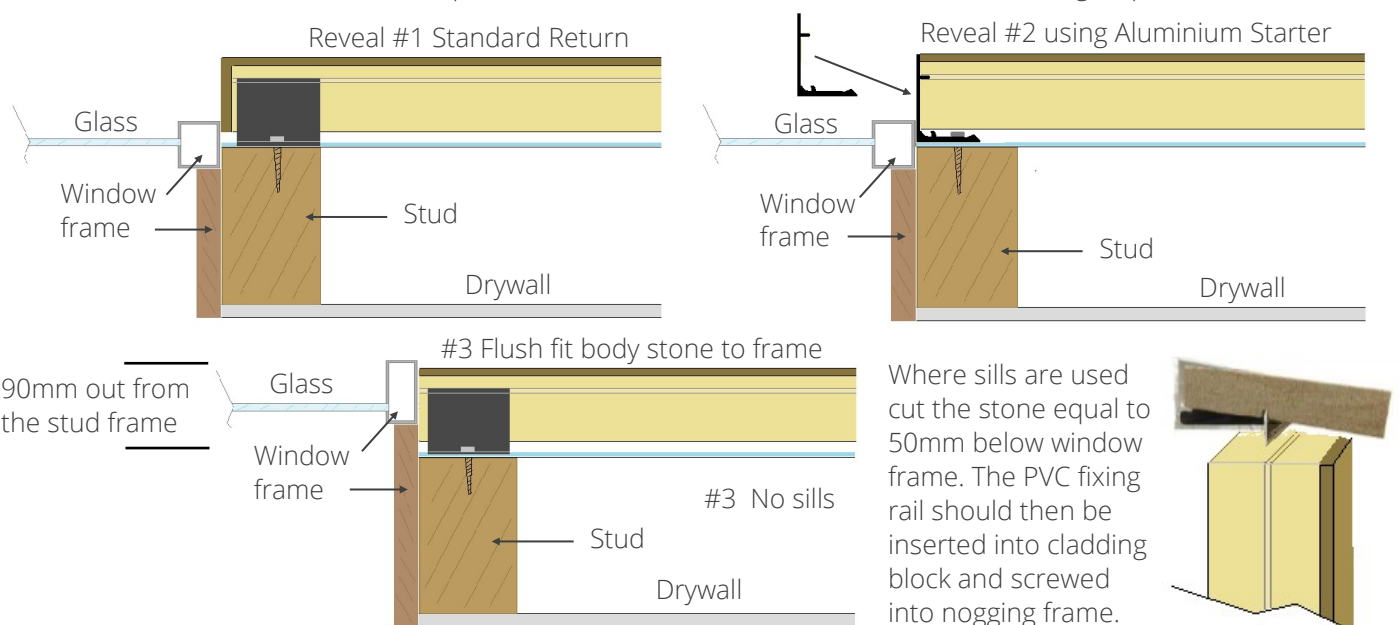

7. Window, Door Headers and Soffit

The illustrations below show window and door header options. #1 utilizing the metal or aluminium 'L' shape section lintel. The cladding should be trimmed to sit level with the top of the adjacent course. Then glued flush to the batten and to the lintel at bottom. Slide joiners vertically in from top as outlined previously.

#2 option utilizes the solid 80mm x 20mm stone. This is cut to suit and wedged firmly with the batten being fitted bottom edge glued after to ensure it is held level in position until the body stone is fitted and glued above. (This may require propping from underneath until adhesive is cured).

The top course is trimmed to suit the opening, then swung into place bottom first into joiners and pressed firmly onto the adhesive coated batten at the top.

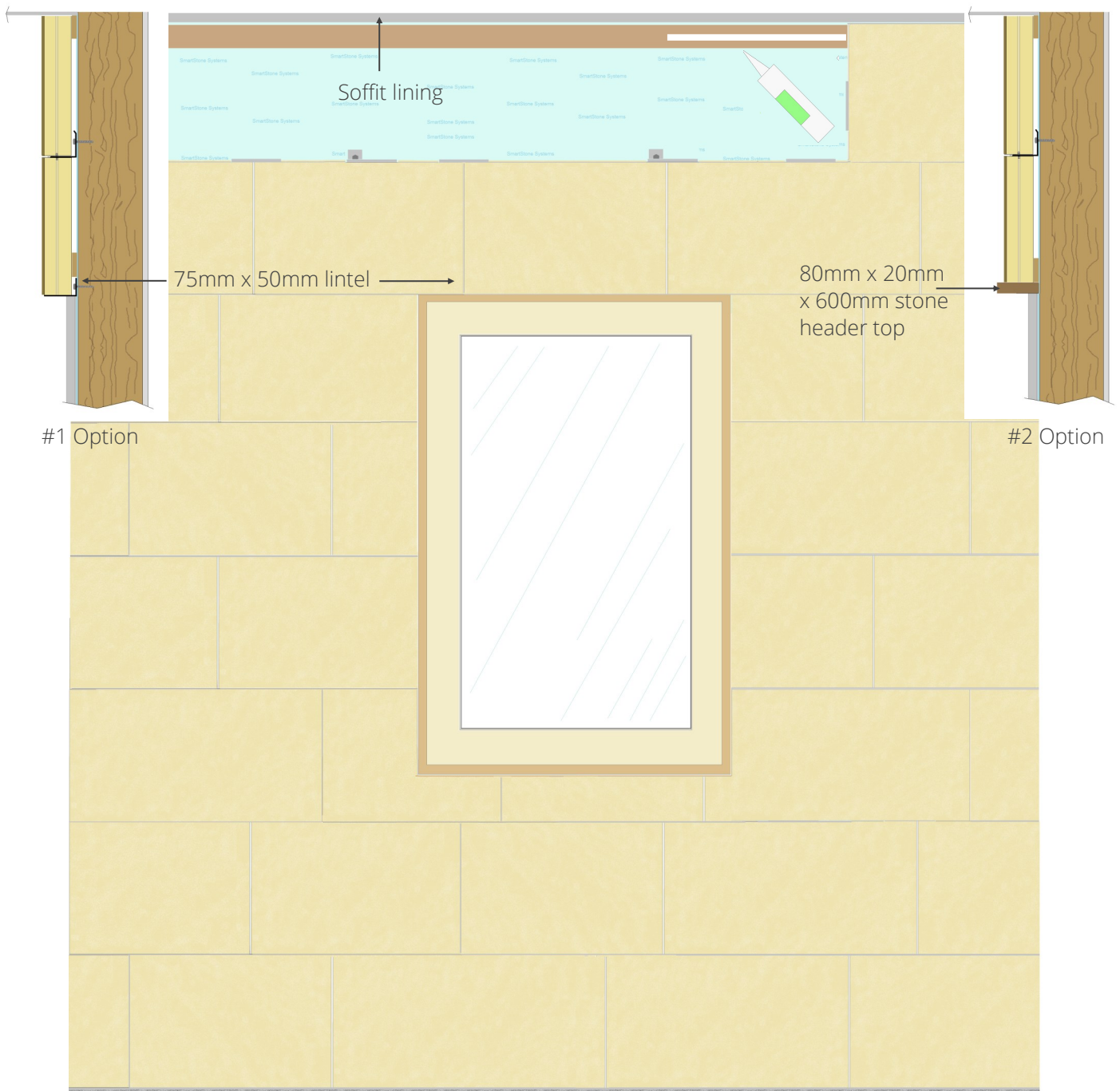

8. Roof Pitches, Gables or Sloping Ground,

Illustrations below demonstrate the best procedure for upper walls to pitched roof and gables. Generally the angle is similar so most leftover stone scribed to suit pitch can be turned around and used in other areas top or bottom. Starter rail should be placed at longest point from bottom at 300mm or just less, unless it needs to marry with other courses already done in order to match up horizontally. For ease when doing the acute angles always install the most acute first. #1

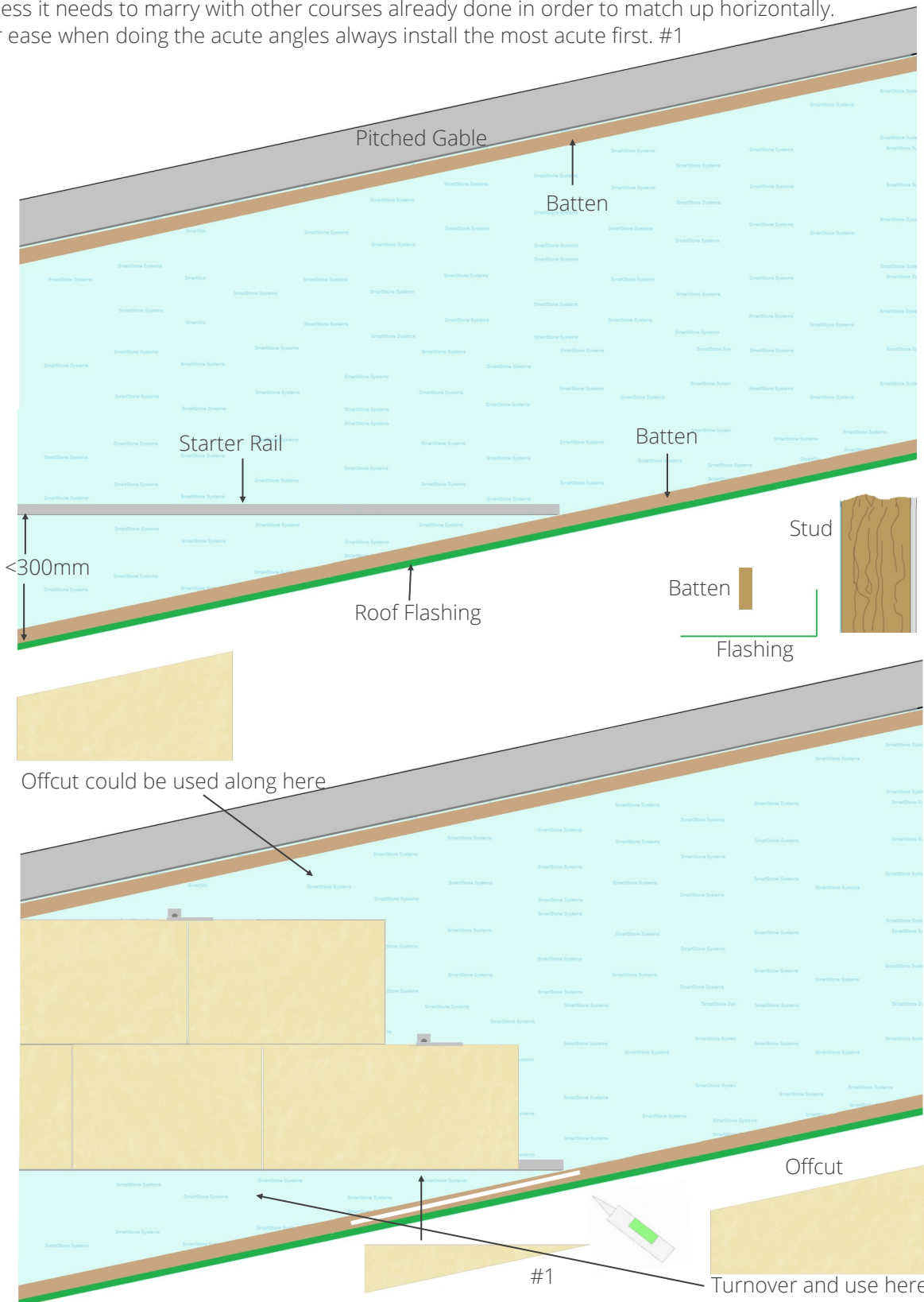

9. Weight Bearing Attached Structures

Heavy structures should not be affixed through the stone cladding. A back plate should be attached to the studs matching the end plate of the (in the illustration below) roof rafters on a pergola/veranda. This provides the structural strength required. It also makes the stone installation simpler, neater and faster as no cutting around the rafters is required. Once the structure is fixed to the studs any roofing and flashing can be fixed as per drawing. Then the upper stone cladding can be fixed. With some roofing such as corrugated iron the flashing and cladding could be done before the roofing iron is installed. (In this situation sufficient space should be allowed for the corrugated iron to be snugly slid underneath later.)

Flashings from second floor walls to gable roofs can be treated with similar flashing detail. Tile roofs can be accommodated in advance with use of flexible flashing or lead to enable raising for placement of tiles later. Co-ordinate with your roofing professional for the best wall/roof flashing advice relative to your project.

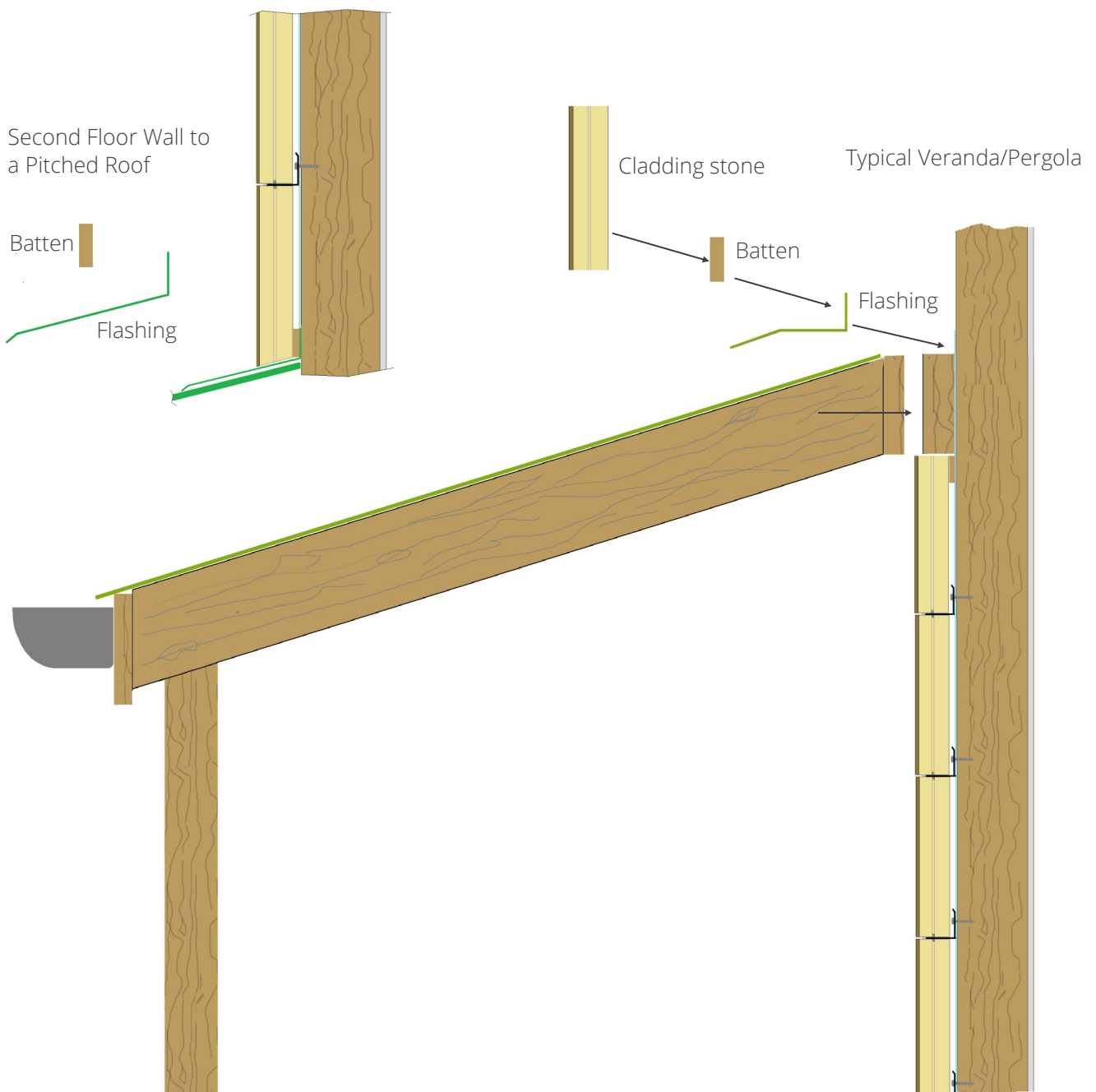

The 7 simple steps to the replacement of a broken or damaged stone panel

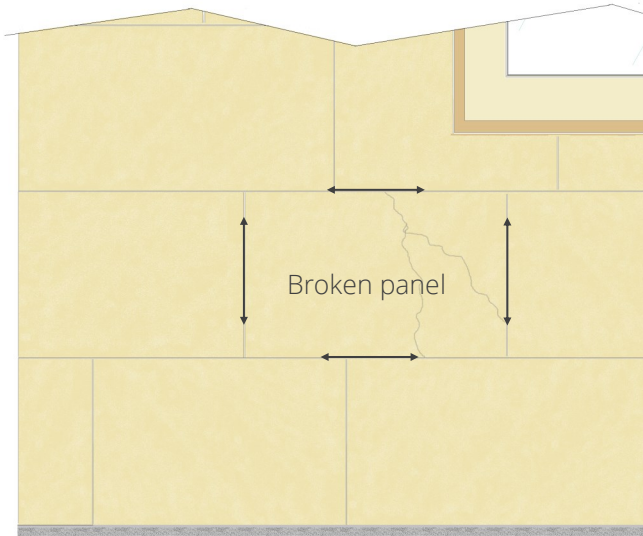

1. Using a razor knife cut around outside joint of the damaged tile to release the adhesive sealant

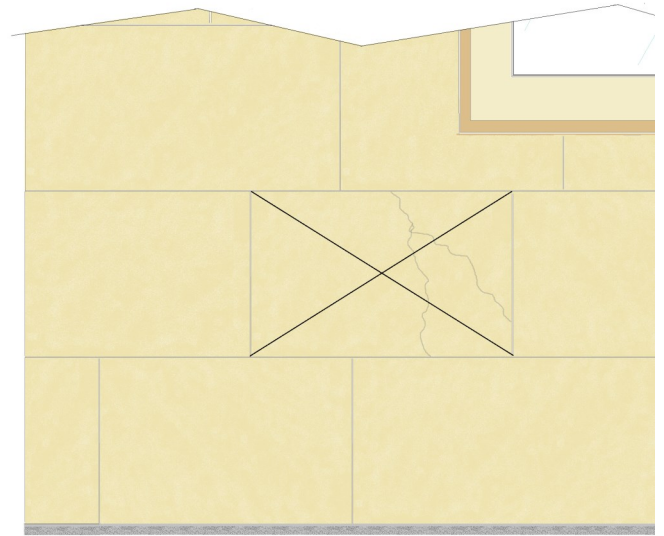

2. Using a masonry blade angle grinder cut through the stone face to all corners as shown above. When done with the razor knife cut through the insulation board to the rear of the tile. This cut is best done on an V style angle to facilitate leverage in removing it without it wedging itself tight on extraction. Once the first section of the 4 is out it is relatively easy to then remove the rest. Clean up any old adhesive sealant around all the perimeter area ready for the replacement panel..

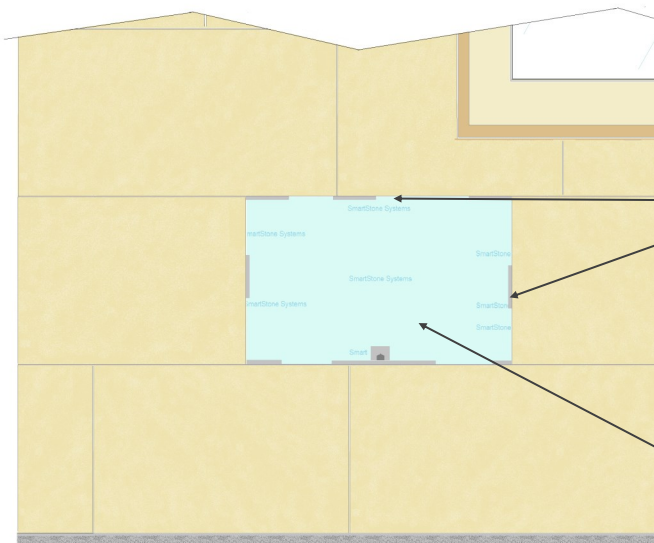

3. Carefully cut the replacement panel to the size required.

Replacement tile cut to size

Adhesive Sealant

Fig A

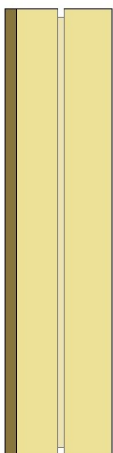

4. With the replacement tile cut to correct size and checked for fit Fig A) mark out as shown in Fig B) for cut-out to the depth of the existing joining groove. Clear all 4 sides with a fine tooth saw or a razor knife so that it is stepped as shown in Fig C)

Fig B



Fig C

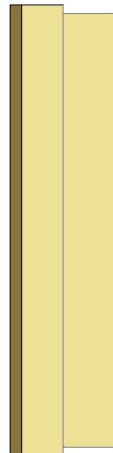

5. Apply adhesive sealant to all 4 sides behind the step.

6. The tile can now be placed into the opening pressing firmly to obtain good sealant contact.

7. Grout or seal at front face to suit the existing finish.

Fig D

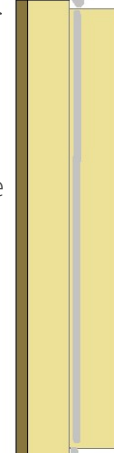

Recommended installation for direct fix to solid substrates (Chemical and Mechanical fixing)

SmartStone Systems can supply stainless steel bottom rails and Z clips for such direct fixing installations. Used in conjunction with *Expanda BOND* polyurethane adhesive this results in a solid structural bond in a one step process. Use of the standard alignment joiners ensures a perfect neat application. Hidden fixings mean no temporary fixing required - Walk away when finished. One only needs to come back for grouting of Joints if the job requires it.

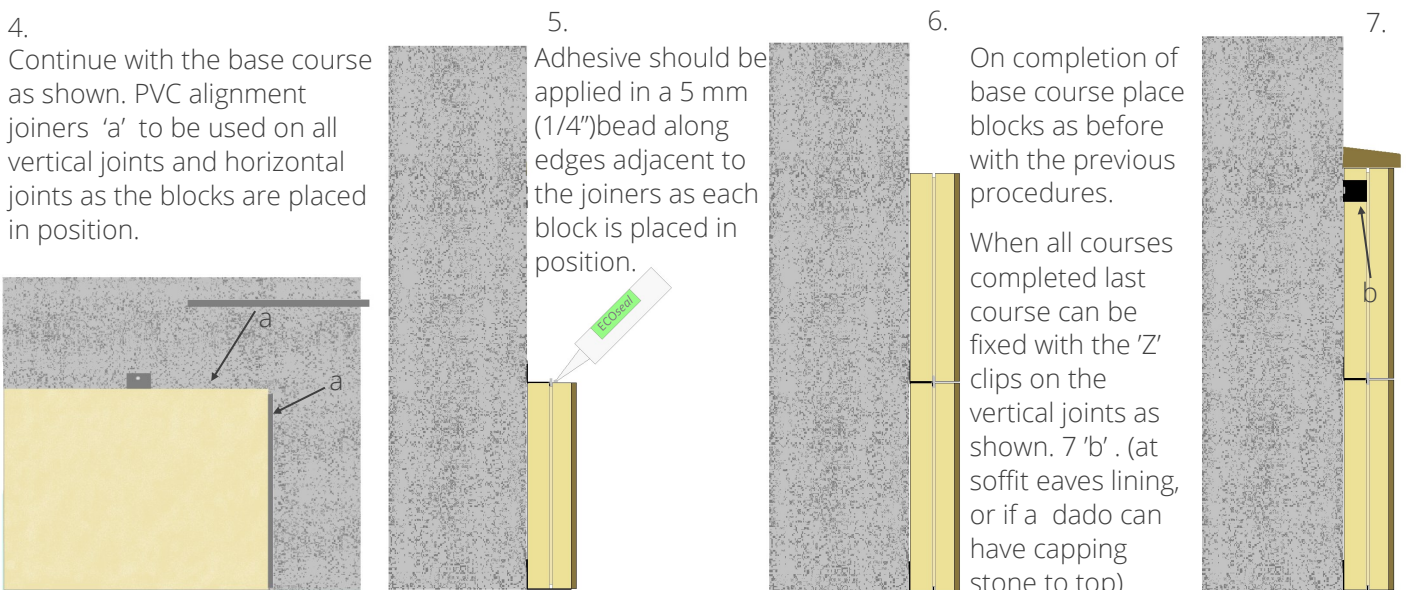
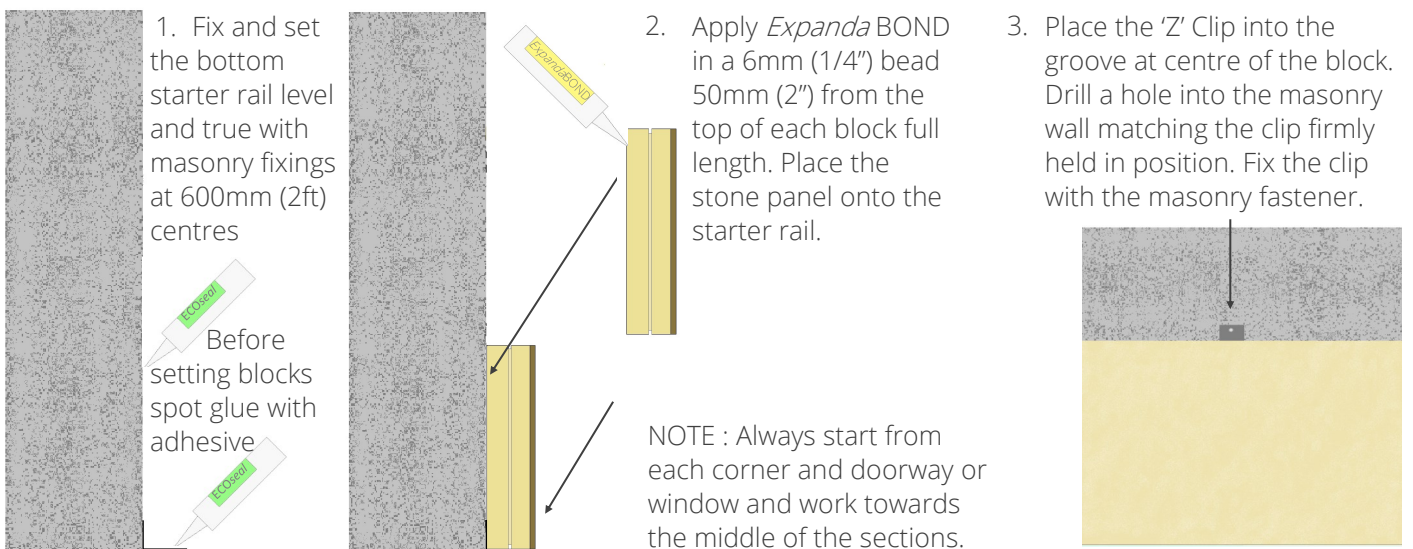
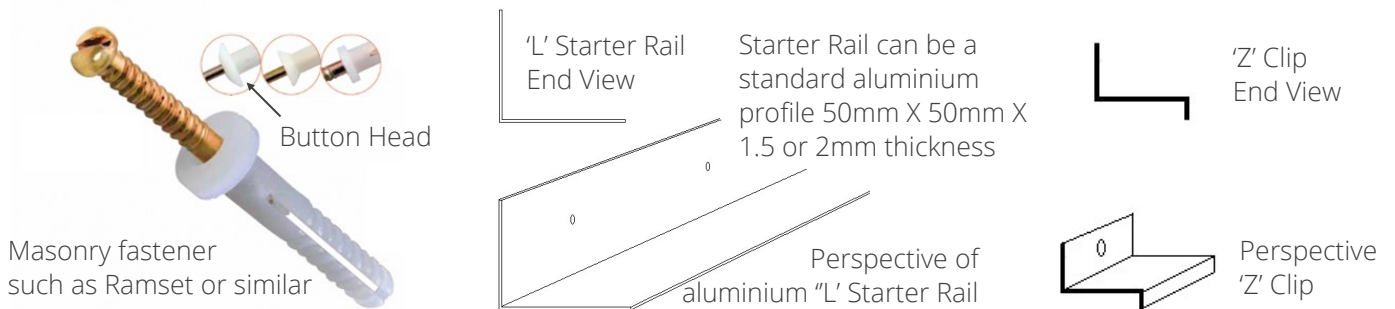

NOTE : *ExpandaBOND* is moisture cured therefore it is OK on damp substrates or green concrete unlike many other adhesives. It expands with exposure to moisture at about 3 >4 times original application volume. Use sparingly.

10. Retrofit and Direct Fixing to Masonry and Fibre Reinforced Sheet

Retrofit over weather boards and existing fibro sheeting can be performed using the SmartClips with longer thread ends to ensure at least 30mm penetration into the stud wall framing. Studs should be found and marked prior to installation. Minor undulations can be countered by adding packers behind the clips or rail. It is not advisable to direct adhesive fix to weatherboards or older fibro cement sheeting unless they are in sound condition and existing fixings are sufficient to carry the extra load added with the cladding material.

Concrete block, brick and masonry walls can be clad using direct fix with good quality brand Silicone or Polyurethane adhesive using 20 cent blob method with at least 9 blobs evenly spaced on each tile backing. Check polyurethanes for any solvents which may affect the backing insulation. When applied they should be pressed and wriggled to ensure a good bond grip. With direct fix it is still recommended to use the alignment joiners (vertical and horizontal) as they maintain a level front face regardless of the existing building face. Where excessive undulations occur it may require shaving some off the back of the stone cladding tile, or otherwise packing a little, which is quite simple.

Retrofit is a great way to gain a beautiful totally new façade, and enjoy the comfort of an insulated building, without removal (most cases) of existing internal or external material in order to install insulation between the studs. This results in great savings, not to mention the savings if existing cladding is asbestos based which has a high cost for safe removal if sought.

Note : SmartStone Systems standard range of insulated backing are a B1 fire rated material They will not sustain or support flame or fire when without source fire. They are however not designed for use in fire places where direct flame is exposed or very high heat is expected to be present.

Where a total non combustible A1 rated material is specified please consult us about our FirePlus insulated A-1 fire rated stone cladding.

Wishing you a happy new build with SmartStone Systems or a stunning retrofit revival of your old.



We do our best to have as much informative information as possible for consumers, and to try and keep it simple to understand. If there is anything that is found ambiguous or confusing we appreciate your feedback so that we can make adequate changes for others in the future. Thanks to those that do assist here.

SmartStone Systems Limited, Unit 1618, 16/F, Mirimar Tower, 132 Nathan Road, Tsim Sha Tsui, Kowloon, Hong Kong. Manufacturing - He Tou Industrial Zone, Zhangjiagang, Suzhou, Jiangsu Province, China

www.smartstonesystems.com

Email - smartstonesystems@gmail.com

Phone + 61 452540007

techstone
beauty and durability in reconstituted stone

Le'Ceramica
insulated porcelain cladding panels

ecosmart
insulated lightweight cladding systems



2014 This document is covered by Copyright and no parts or parts thereof shall be reproduced, copied and/or used without the express consent of SmartStone Systems Limited in writing.

Disclaimer... Information in this guide is provided in good faith and with best work practises in mind. All reasonable care has been taken in the preparation of this information. The manufacturer does not provide warranty of merchantability or any other warranty, expressed or implied, with respect to this information. The manufacturer makes no representations and assumes no liability for any direct, incidental or consequential damages resulting from its use. The manufacturer warrants its physical products when purchased for the purposes they are designed and marketed for. The manufacturer warrants such physical products produced and sold by the manufacturer or its authorised agents/distributors for a period of 15 years from date of purchase. Such product shall be installed in accordance with instructions and any trades work to clients must be performed by qualified licensed tradespersons. Any claims made shall be accompanied by a full receipt for such works and the trade details or the firm who performed the work. The manufacturer reserves the rights to inspect such projects being the subject of any claim and that they be provided access by its inspectors whenever reasonably necessary.